



iXchange[®] Learning Wall Systems

specifications

Classic Construction (/C)

<i>Case</i>	Classic Cabinet (sides, back and sub-top/sub-bottom) are constructed using fully doweled 0.75" particle board with double sided thermal fused laminate (TFL) with 3mm PVC edge banding*.
<i>Drawers</i>	0.75" matching front w/3mm PVC edge banding*, 4" satin nickel wire pulls, standard full extension side mount steel ball bearing glides
<i>Doors</i>	0.75" double sided TFL, 3mm PVC edge banding*, 4" satin nickel pulls and 6-point adjustable concealed hinges (European hinge).
<i>Shelves</i>	Double sided TFL, 3mm PVC edge banding* on front edge, adjustable shelves have four double-pin shelf clips per shelf to prevent the shelves from sliding out or tipping, fixed are fully doweled
<i>Modular Base</i>	Integrated, matching fully finished 4" base, 3mm PVC edge banding*, built in levelers adjustable from inside of cabinet

Premium Construction (/P)

<i>Premium Construction</i>	Premium cabinets are constructed the same as Classic cabinets, except the Premium cabinet components are double sided high pressure laminate (HPL) in place of the double sided TFL. *3mm PVC edge banding is matching, unless otherwise specified. Complementary color available upon request.
-----------------------------	--

Features

<i>Whiteboards</i>	Aluminum horizontal sliding panel system with two whiteboards standard, optional third whiteboard. Porcelain-on-steel marker surface guarantees a durable, high-performance board. Marker board frame constructed of anodized aluminum trim and includes a cork map rail. Magnetic panels glide on nylon rollers for smooth operation. Finger pull for easy operation and tray for markers.
--------------------	---

Assembly

<i>On Site Assembly</i>	Each individual cabinet comes fully doweled. Assembly of of entire unit to include installation of the board and rail system required on site. See assembly instructions on our website: www.wibenchmfg.com/resources/product-information/
-------------------------	---

Additional Options

	<i>Adder Code</i>	<i>Description</i>
<i>Locks</i>	N/A	Deadbolt locks per location

Shipping Class: Density Based Class

NMFC: 80440

Assembly: Some Assembly Required



NEW

6 ft Wall

SSW0614

- Two - 23.5" 2-Door Base Units w/Adj. Shelf
- One - 23.5" 3-Drawer Base Unit
- One - 35.5" Center Opening
- Two - 18.25" Wall Hutch Units w/Adj. Shelves/Dividers
- Four - Porcelain Whiteboards

Model #	Wgt	W" x H"	Classic List \$ (/C)	Premium List \$ (/P)
SSW0614	833	72 x 60	18852	21970

Top Cabinet D: 17.75", Base Cabinet D: 23" **Overall Depth: 24.35"**
 # of OPTIONAL locks required: 5

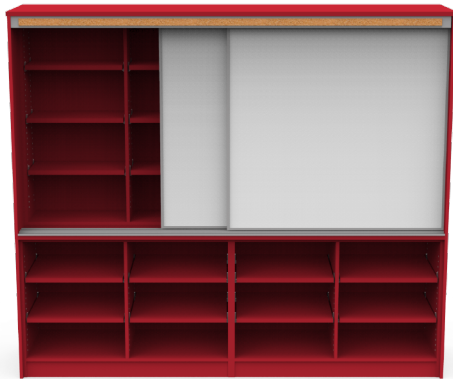

8 ft Wall

SSW0801-AL

- Two - 48" Open Base Units w/Adj. Shelves/Dividers
- Two - 48" Wall Hutch Units w/Adj. Shelves/Dividers
- Two - Porcelain Whiteboards

Model #	Wgt	W" x H"
SSW0801-AL	1107	96 x 84

Top Cabinet D: 17.75", Base Cabinet D: 23" **Overall Depth: 24.35"**

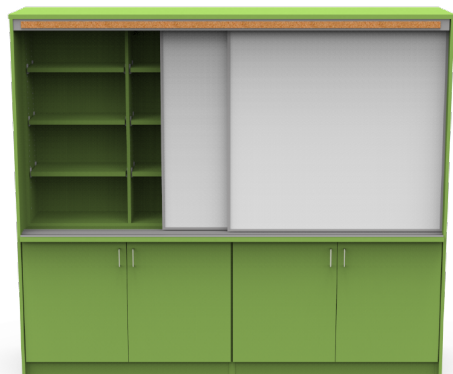

8 ft Wall

SSW0802-AL

- Two - 48" 2-Door Base Units w/Adj. Shelves/Dividers
- Two - 48" Wall Hutch Units w/Adj. Shelves/Dividers
- Two - Porcelain Whiteboards

Model #	Wgt	W" x H"
SSW0802-AL	1139	96 x 84

Top Cabinet D: 17.75", Base Cabinet D: 23" **Overall Depth: 24.35"**
 # of OPTIONAL locks required: 4



8 ft Wall
SSW0804-AL

- Two - 32" 2-Door Base Units w/Adj. Shelf
- One - 32" 3-Drawer Base Unit
- Two - 48" Wall Hutch Units w/Adj. Shelves/Dividers
- Two - Porcelain Whiteboards

Model #	Wgt	W" x H"
SSW0804-AL	1239	96 x 84

Top Cabinet D: 17.75", Base Cabinet D: 23" **Overall Depth: 24.35"**
of OPTIONAL locks required: 5



10 ft Wall
SSW1001-AL

- Two - 30" 2-Door Base Units w/Adj. Shelves
- Two - 30" Open Base Units w/Adj. Shelves
- Two - 36" and One - 48" Wall Hutch w/Adj. Shelves
- Two - Porcelain Whiteboards

Model #	Wgt	W" x H"
SSW1001-AL	1410	120 x 84

Top Cabinet D: 17.75", Base Cabinet D: 23" **Overall Depth: 24.35"**
of OPTIONAL locks required: 2



10 ft Wall
SSW1002-AL

- Two - 30" 2-Door Base Units w/Adj. Shelf
- Two - 30" 2-Door/2-Drawer Base Units w/Adj. Shelf
- Two - 36" and One - 48" Wall Hutch w/Adj. Shelves
- Two - Porcelain Whiteboards

Model #	Wgt	W" x H"
SSW1002-AL	1506	120 x 84

Top Cabinet D: 17.75", Base Cabinet D: 23" **Overall Depth: 24.35"**
of OPTIONAL locks required: 8



10 ft Wall
SSW1004-AL

- Two - 40" 2-Door Base Units w/Adj. Shelf
- One - 40" 3-Drawer Base Unit
- Two - 36" and One - 48" Wall Hutch w/Adj. Shelves
- Two - Porcelain Whiteboards

Model #	Wgt	W" x H"
SSW1004-AL	1531	120 x 84

Top Cabinet D: 17.75", Base Cabinet D: 23" **Overall Depth: 24.35"**
of OPTIONAL locks required: 7



12 ft Wall
SSW1201-AL

- Three - 48" 2-Door Base Units w/Adj. Shelves/Dividers
- Three - 48" Wall Hutch Units w/Adj. Shelves/Dividers
- Two - Porcelain Whiteboards

Model #	Wgt	W" x H"
SSW1201-AL	1657	144 x 84

Top Cabinet D: 17.75", Base Cabinet D: 23" **Overall Depth: 24.35"**
of OPTIONAL locks required: 6



12 ft Wall
SSW1202-AL

- Two - 36" 2-Door Base Units w/Adj. Shelf
- Two - 36" 2-Door/2-Drawer Base Units w/Adj. Shelf
- Three - 48" Wall Hutch Units w/Adj. Shelves/Dividers
- Two - Porcelain Whiteboards

Model #	Wgt	W" x H"
SSW1202-AL	1751	144 x 84

Top Cabinet D: 17.75", Base Cabinet D: 23" **Overall Depth: 24.35"**
of OPTIONAL locks required: 8



12 ft Wall

SSW1204-AL

- Two - 48" 2-Door Base Units w/Adj. Shelves/Dividers
- Two - 24" 3-Drawer Base Units
- Three - 48" Wall Hutch Units w/Adj. Shelves/Dividers
- Two - Porcelain Whiteboards

Model #	Wgt	W" x H"
SSW1204-AL	1763	144 x 84

Top Cabinet D: 17.75", Base Cabinet D: 23" **Overall Depth: 24.35"**
 # of OPTIONAL locks required: 10



NEW

12 ft Wall

SSW1211-AL

- Three - 48" 2-Door Base Units w/Adj. Shelves/Dividers
- Two - 39" Wall Hutch Units w/Adj. Shelves/Dividers
- Four - 36" Porcelain Whiteboards
- One - 64.5" Opening to fit up to 70" TV

Model #	Wgt	W" x H"
SSW1211-AL	1506	144 x 84

Top Cabinet D: 17.75", Base Cabinet D: 23" **Overall Depth: 24.35"**
 # of OPTIONAL locks required: 10

TV & hardware to mount TV are not included.
 Support bars included for back panel and subtop.